

England & Wales		
EU Directive 2002/91/EC		
		
Potential	Current	

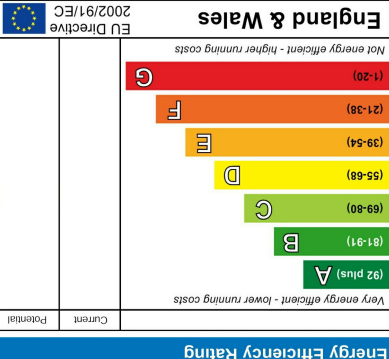

www.justproperty.net

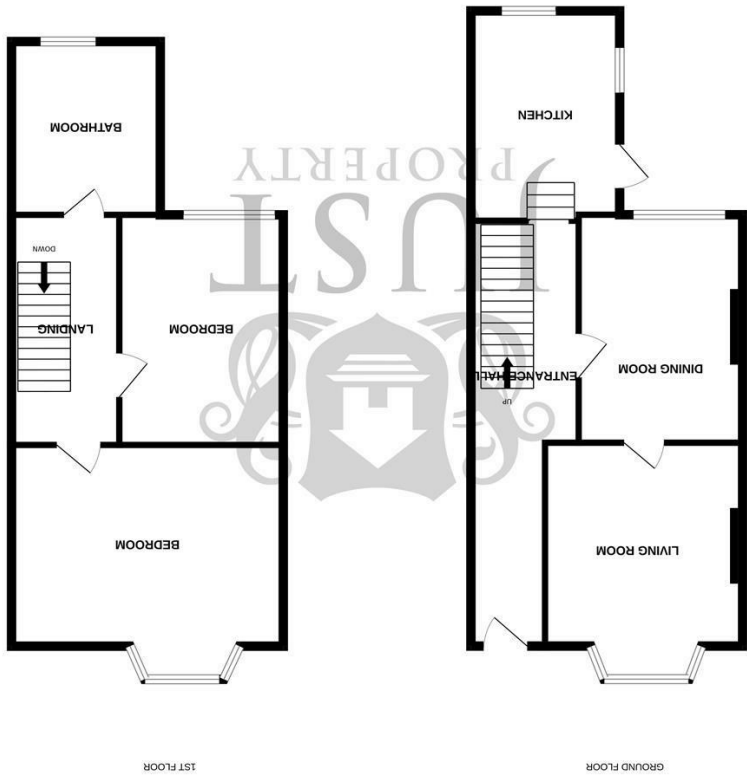
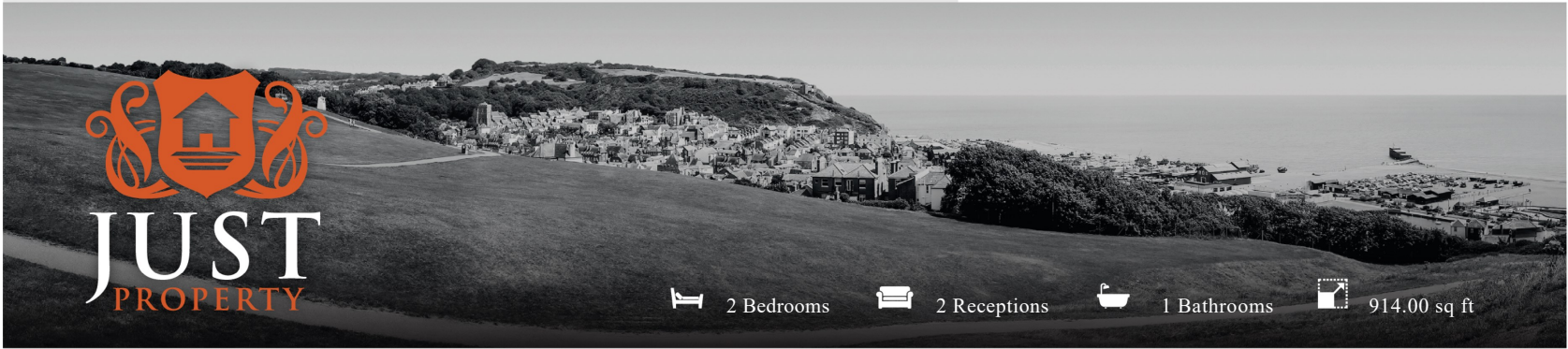

2 Bedrooms 2 Receptions 1 Bathrooms 914.00 sq ft

13 Lower South Road, St. Leonards-On-Sea, TN37 6RH

Freehold

£235,000





Freehold

£235,000



2 Bedrooms



2 Receptions



1 Bathrooms



914.00 sq ft

PROPERTY DETAILS

CHAIN FREE

This spacious two-bedroom mid-terrace period property is located on a quiet residential street in upper St. Leonards. Ideally positioned, it's close to local shops, bus routes, and schools, with the seafront and promenade of St. Leonards and Hastings just a short distance away.

Offered chain-free, the property welcomes you with a spacious entrance hallway, leading to a bay-fronted living room and a separate dining room. There's a well-fitted kitchen/breakfast room with a handy storage cupboard and access to the rear courtyard garden. On the first floor, the galleried landing opens to a large family bathroom, a generously-sized double bedroom, and a bay-fronted principal bedroom with built-in wardrobes, providing a bright, airy atmosphere and ample space.

The property features UPVC double glazing, gas-fired central heating, and is available chain-free.

To fully appreciate the space and location of this charming period mid-terrace home, viewings are highly recommended. Please contact Just Property for further details.



ROOM DIMENSIONS

Front Door

Hallway

Family Lounge
13'7" x 10'9" (4.15 x 3.29)

Dining Room
11'3" x 8'8" (3.44 x 2.65)

Under Stairs Storage

Kitchen / Breakfast Room
14'2" x 7'11" (4.33 x 2.42)

Stairs To Galleried Landing

Bedroom
14'1" x 13'11" (4.31 x 4.25)

Bedroom
11'3" x 8'7" (3.44 x 2.64)

Bathroom
12'2" x 8'2" (3.73 x 2.49)

Front Garden Area

Rear Courtyard

FEATURES

- CHAIN FREE
- Two Double Bedrooms
- Fitted Kitchen / Breakfast Room
- Gas Central Heating (not tested)
- Bay Fronted Family Lounge
- Separate Dining Room
- Central St Leonards Position
- Mid Terrace Period Property
- Rear Courtyard Garden

